

# Technical data sheet

## Clamp clip, single, FT metal pressure trough

Item number: 1158015



Suitable for all C profile rails with slot width 18 mm and 22 mm.

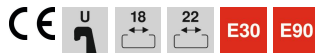

**St** Steel

**FT** Hot-dip galvanised

### Master data

|                     |                          |
|---------------------|--------------------------|
| Item number         | 1158015                  |
| Type                | 2056U M 16 FT            |
| Description 1       | Clamp clip               |
| Description 2       | with metal pressure sump |
| Manufacturer        | OBO                      |
| Dimension           | 12-16mm                  |
| Material            | Steel                    |
| Surface             | Hot-dip galvanised       |
| Surface standard    | DIN EN ISO 1461          |
| Smallest sales unit | 100                      |
| Unit of quantity    | Piece                    |
| Weight              | 3.52 kg                  |
| Weight unit         | kg/100 pc.               |

# Technical data sheet

## Clamp clip, single, FT metal pressure trough

Item number: 1158015



### Dimensions

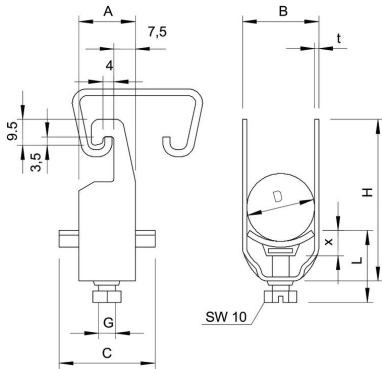

|                  |        |
|------------------|--------|
| Dimension A      | 20 mm  |
| Dimension B      | 20 mm  |
| Dimension C      | 34 mm  |
| Dimension G (mm) | M6     |
| Dimension H      | 46 mm  |
| Dimension L      | 34 mm  |
| Dimension t      | 1.5 mm |
| Dimension x      | 5 mm   |

### Technical data

|                                                |                |
|------------------------------------------------|----------------|
| Number of cables/pipes                         | 1              |
| For pipe diameter, max.                        | 16 mm          |
| For pipe diameter, min.                        | 16 mm          |
| for rail with slot width (with interval), max. | 22 mm          |
| for rail with slot width (with interval), min. | 18 mm          |
| Halogen-free                                   | no             |
| Max. Tightening torque                         | 3 Nm           |
| With plastic trough                            | no             |
| With metal trough                              | yes            |
| Mounting type                                  | Profile rail   |
| Impact-resistant                               | no             |
| Clamping range D, max.                         | 16 mm          |
| Clamping range D, min.                         | 12 mm          |
| Surface addition                               | hot galvanised |
| Material addition                              | Steel          |
| With counter-trough                            | no             |
| Material of trough                             | Steel          |