

# Technical data sheet

## Support bracket AS 30

Item number: 6419376



Medium-duty support bracket for infinitely adjustable fastening on IS 8 support. The support bracket can be fastened to both sides of the I support.

The individual clamping lug, including bolt, nut and washer can also be ordered separately under the item no. 6419007.

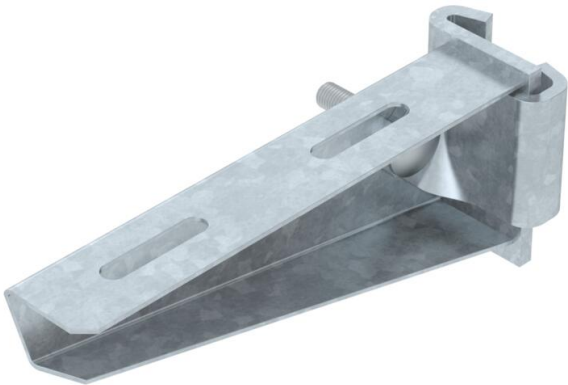

**St** Steel

**FT** Hot-dip galvanised

### Master data

|                     |                    |
|---------------------|--------------------|
| Item number         | 6419376            |
| Type                | AS 30 16 FT        |
| Description 1       | Support bracket    |
| Description 2       | for IS 8 support   |
| Manufacturer        | OBO                |
| Dimension           | B160mm             |
| Material            | Steel              |
| Surface             | Hot-dip galvanised |
| Surface standard    | DIN EN ISO 1461    |
| Smallest sales unit | 1                  |
| Unit of quantity    | Piece              |
| Weight              | 37 kg              |
| Weight unit         | kg/100 pc.         |

# Technical data sheet

## Support bracket AS 30

Item number: 6419376



### Dimensions

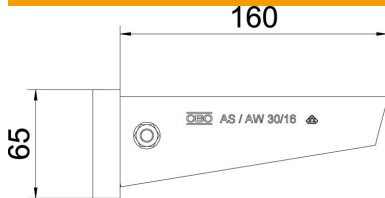

|             |        |
|-------------|--------|
| Length      | 41 mm  |
| Width       | 160 mm |
| Height      | 65 mm  |
| Dimension A | 41 mm  |
| Dimension B | 160 mm |
| Dimension H | 65 mm  |

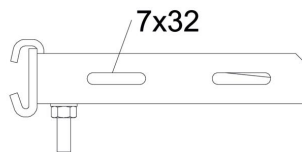

### Technical data

|                               |                 |
|-------------------------------|-----------------|
| Version for                   | Support bracket |
| F in kN                       | 3 kN            |
| Maintain electrical functions | no              |
| Rustproof steel, pickled      | no              |

### Loads

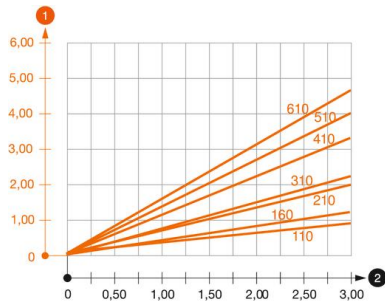

#### Load diagram, bracket type AS 30

- 1 Bending of the bracket tip at permitted bracket load
- 2 Permitted bracket load in kN without man load
- Load curve with bracket lengths in mm