

Technical data sheet

45° mounting angle A2

Item number: 6017339



45° installation profile, vertical, for C mesh cable tray and GR-Magic® mesh cable tray with a side height of 55 mm.
Each with two clamps of type KS 23 35.
Including connector, to create 45° bends.

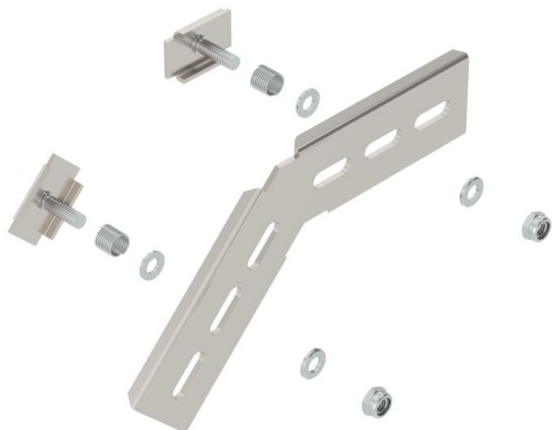

A2 Stainless steel

2B Bright, treated

Master data

Item number	6017339
Type	MW 45 SL10 A2
Description 1	45° installation angle
Description 2	for C-mesh cable tray
Manufacturer	OBO
Dimension	178x103
Material	Stainless steel
Surface	Bright, treated
Surface standard	
Smallest sales unit	20
Unit of quantity	Piece
Weight	20 kg
Weight unit	kg/100 pc.

Technical data sheet

45° mounting angle A2

Item number: 6017339



Dimensions

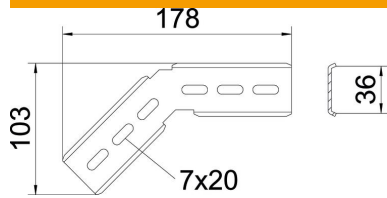

Dimension	178 x 103
-----------	-----------

Technical data

Rustproof steel, pickled	no
--------------------------	----