

Technical data sheet

90° mounting angle FT

Item number: 6017347



90° installation profile, vertical, for C mesh cable tray and GR-Magic® mesh cable tray with a side height of 55 mm.
Each with two clamps of type KS 23/35.
Including connector, to create 90° bends.

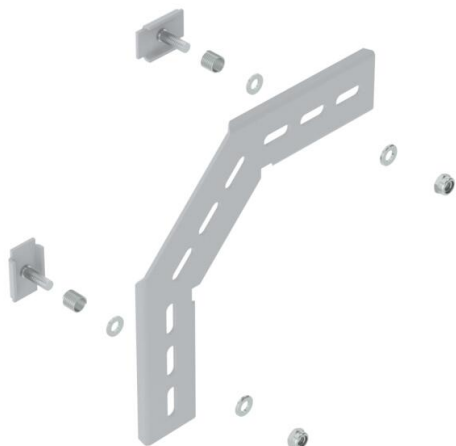

St Steel

FT Hot-dip galvanised

Master data

Item number	6017347
Type	MW 90 SL17 FT
Description 1	90° installation angle
Description 2	for C-mesh cable tray
Manufacturer	OBO
Dimension	170x170
Material	Steel
Surface	Hot-dip galvanised
Surface standard	DIN EN ISO 1461
Smallest sales unit	20
Unit of quantity	Piece
Weight	24.89 kg
Weight unit	kg/100 pc.

Technical data sheet

90° mounting angle FT

Item number: 6017347



Dimensions

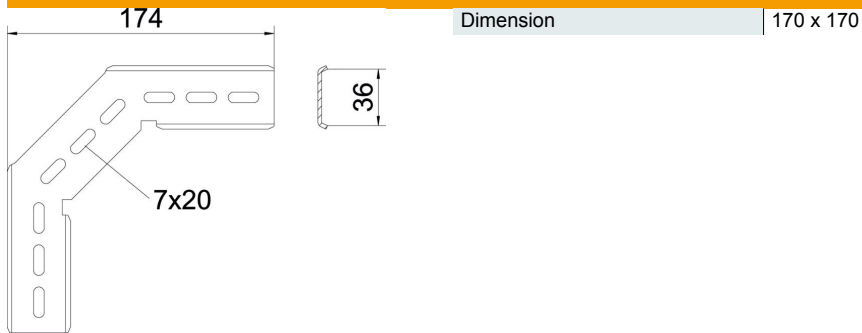

Technical data

Rustproof steel, pickled | no