

Technical data sheet

Connection element for installation in the insulated interception rod isFang IN
Item number: 5408024



- Screw-on termination of the connection for the isCon® cable
- Connection and installation of the cable in the insulated interception rod
- Tested up to 150 kA (lightning protection Class II)



A2 Stainless steel

Master data

Item number	5408024
Type	isCon IN connect
Description 1	Connection element
Description 2	for isCon conductor, internal
Manufacturer	OBO
Dimension	Ø23mm
Material	Stainless steel
Smallest sales unit	1
Unit of quantity	Piece
Weight	26.9 kg
Weight unit	kg/100 pc.

Technical data sheet

Connection element for installation in the insulated interception rod isFang IN

Item number: 5408024



Dimensions

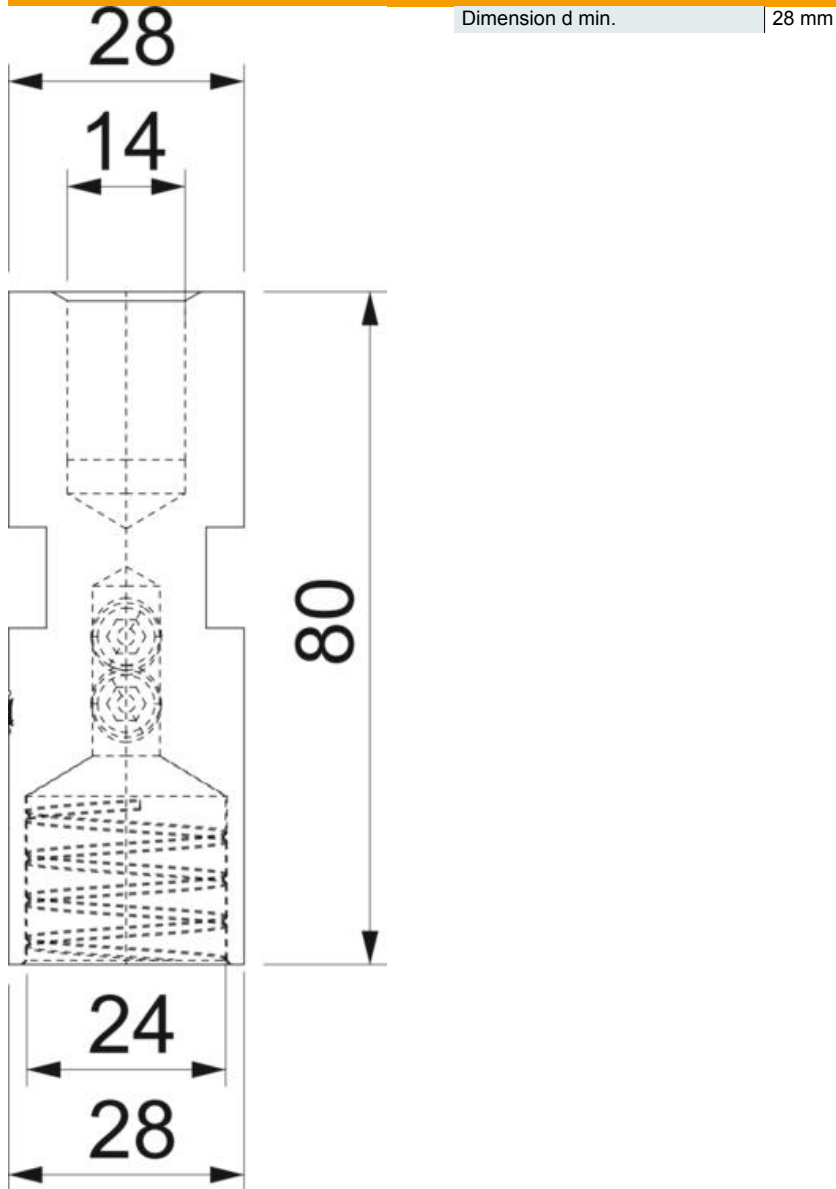

Technical data

Lightning current carrying capacity	H1/150 kA
Suitable for connection	Miscellaneous
Fit	23 mm
Clamping range, max.	23 mm