

Floor boxes GES...KV, RKSN...KV Mounting instructions

Installation pipes M20 and M32 are mounted to the blank of the side walls of the UZD350-3R casting box. There are separate casting boxes for the floor channels. The collar part of the casting box is adjusted to the level of the floor casting surface with the adjusting screws of the corners. The minimum height of the casting box is 70mm and it can be adjusted with raising screws to 70.... 125mm.

NOTE: If the plugs must fit under the closed cover, the minimum height is 80mm.

Place the casting boxes in the right position in the desired location. Connect the installation pipes. Seal the openings in the box with the included tape.

Connect the PE conductor to the bottom part of the casting box with the included ground terminal.

Make sure that the mass is pervaded and that it fills up entirely the space under the collar so that there are no empty spaces. When needed, the collar of the box can be insulated max 3mm from the surface of the cast with an insulation tape.

Removing the protective cover of the casting box and mounting the floor box

The protective cover of the casting box is removed after the cast and a hatch cover DUG350-3/... included in the delivery is installed in place.

The mounting boxes with the accessories of the floor box are included in the delivery. The installation accessories of the Modul 45 series need to be ordered separately.

The GES-U floor boxes have a 5 mm embedded cover for the floor materials.
The GES-MU floor boxes have a 10 mm embedded cover for the floor materials.
The RKSN floor boxes have a 20 mm embedded cover for the floor materials.

Floor boxes RKSN...KO and UKL...KO Mounting instructions

The floor boxes are suitable for mounting of the hollow-core slab or similar. The hollow cores of the slabs need to be of a min $\varnothing 185\text{mm}$ diameter for the UKL500 box and a minimum of $\varnothing 100\text{mm}$ for the UKL4 box. The hollow core is used both as a space for the cords and as an installation space of the box. The floor box is mounted with an adjustable hatch cover to the opened hollow core or post casting of the hollow-core slab with a reserved space for the hatch cover. The measurements of the reserved space for the boxes are as follows:

RKSN4KO 225x225mm
RKSN9KO 270x270mm
UKL4O 140x300mm
UKL500KO 260x530mm

The cover of the box is mounted with the mounting screws and tightening screws delivered together with the hatch cover. The height of the cover is adjusted to 0... 15mm from the level of the final floor surface. The deliveries of the floor boxes RKSN...KO ja UKL...KO include all the needed parts: Floor box, adjustable hatch cover and the needed mounting box. The mounting accessories for the Modul 45 series need to be ordered separately.

The RKSN floor boxes have a 20mm embedded cover for the floor materials.
The UKL floor boxes have a 10mm embedded cover for the floor materials.

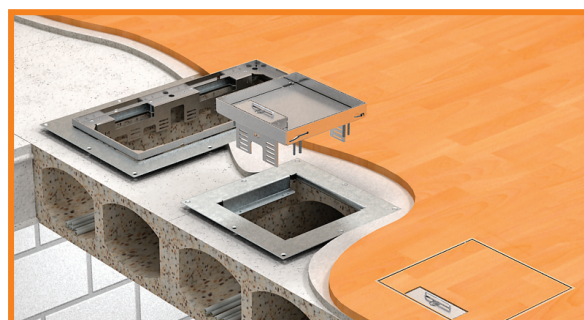
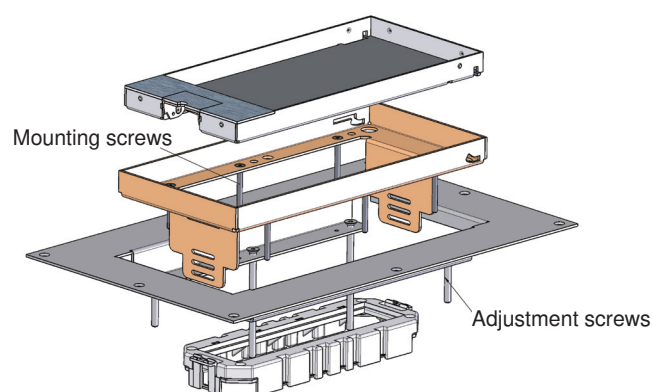
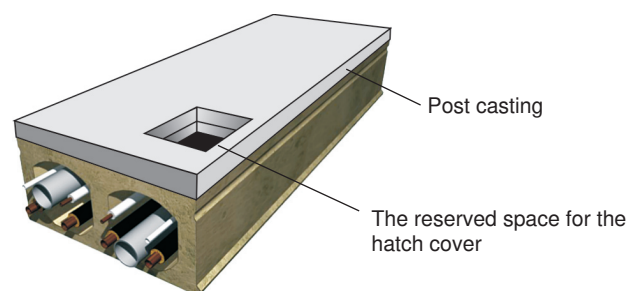
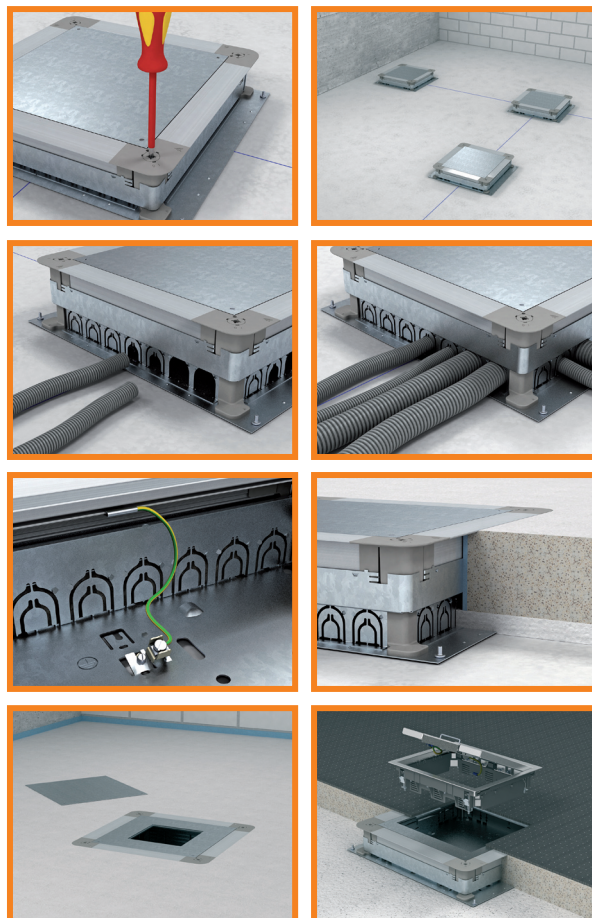

Floor boxes GES...KV, GES...KO, RКСN...KV, RКСN...KO and UKL500KO

User instructions

The aforementioned floor boxes are suitable for dry cleaned floors. Contact us if the floors need to be wet washed. The floor boxes are vacuumed from the inside once a month.

The cover of the floor box is opened by lifting the lifting loop of the cord outlet holes.

When the floor box is in use and the plugs have been mounted to the power outlets, the connection cables need to be placed to the opened outlet hole.

The outlet hole can be locked open or closed. When the box is not used the outlet hole need to be closed.

The mounting height of the mounting boxes ja power outlets inside the floor box can be adjusted by an electrician.

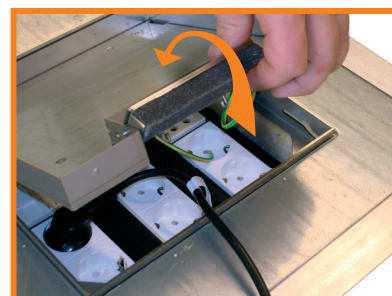

Removing the cover of the floor box

The cover of the floor box can be removed by lifting the cover in an upright position and twisting the cover horizontally. The cover is mounted back in a reverse order.

